



**ADAM
HALLIWELL**

POWERED BY
exp UK

Sunnycroft Close, Bishops Cleeve, Cheltenham, GL52

£415,000

🛏️ 2 🪑 2 🚗 2



- Detached chalet style bungalow
- Two spacious bedrooms (one up and one down)
- Garden cabin
- Driveway
- Landscaped rear garden
- Modern open-plan kitchen
- Further office/occasional bedroom 3
- Workshop and car port
- Refitted wetroom/shower on ground floor
- Half a mile walk to Church road shops



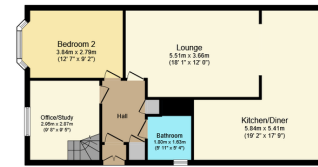

Ground Floor
Floor area 75.7 m² (814 sq.ft.)



First Floor
Floor area 21.2 m² (228 sq.ft.)

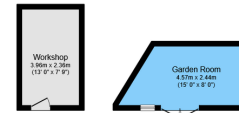

Outbuilding
Floor area 20.4 m² (220 sq.ft.)

TOTAL: 117.3 m² (1,262 sq.ft.)

This floor plan is for illustrative purposes only. It is not drawn to scale. Any measurements, floor areas (including any total floor area), openings and orientations are approximate. No details are guaranteed, they cannot be relied upon for any purpose and do not form any part of any agreement. No liability is taken for any error, omission or misstatement. A party must rely upon its own inspection(s). Powered by www.Propertybox.io

This smart detached chalet style bungalow, featuring neutral decor, offers two reception rooms, a modern kitchen, two spacious bedrooms, two well-appointed bathrooms, a beautifully landscaped garden, a versatile garden cabin, and convenient access to public transport, making it ideal for couples or retirees seeking a serene living space.

| Score | Energy rating | Current | Potential |
|-------|---------------|---------|-----------|
| 92+ | A | | |
| 81-91 | B | | 86 B |
| 69-80 | C | 70 C | |
| 55-68 | D | | |
| 39-54 | E | | |
| 21-38 | F | | |
| 1-20 | G | | |

Call us on

01242 906 586 | 07861 238 913

adamhalliwell@exp.uk.com

Orlando, Old Reddings Road, The Reddings, Cheltenham, GL51 6SA

adam.halliwell.exp.uk.com

Agents Note: Whilst every care has been taken to prepare these particulars, they are for guidance purposes only. All measurements are approximate and are for general guidance purposes only and whilst every care has been taken to ensure their accuracy, they should not be relied upon and potential buyers are advised to recheck the measurements.